



# VENUE PACKET

Updated May 21, 2021



# TABLE OF CONTENTS

---

- 1 | Venue Contacts
- 2 | Truck/Bus Parking
- 3 | Venue Layout/Dimensions
- 4 | Stage Dimensions
- 5 | FOH Positions
- 6 | Rigging/Power
- 7 | Lineset Schedule
- 8 | Lighting
- 9 | Audio
- 10 | Video
- 11 | Venue Pictures
- 26 | Hotels
- 27 | Green Room/Dressing Room
- 28 | Merchandise
- 29 | Airports
- 30 | Lecture Hall/Presenter Info
- 31 | Box Office Seating Chart
- 32 | Amenities



# VENUE CONTACTS

## NISWONGER PERFORMING ARTS CENTER

10700 State Route 118 South  
Van Wert, OH 45891  
United States

### **Executive Director:**

Booking/Contract Info

Tafi Stober

419-771-1176

showtime@npacvw.org

### **House Manager:**

Hospitality

Michelle Agler

419-771-1170

facilities@npacvw.org

### **Marketing Director:**

Quincy Thompson

419-771-1173

quincy@npacvw.org

### **Technical Director:**

(Rentals)

Hugh Saunier

419-771-1177

tech@npacvw.org

### **Operations/Accounting:**

(Rentals)

Matt Saunier

419-771-1175

production@npacvw.org

### **Box Office Manager:**

Amy McGovern

419-238-6722

boxoffice@npacvw.org



# PARKING/LOADING DOCK

1 - truck dock at street level. 12'X8' lift platform to unload.

NOTE: All areas are street level.

\*Bus parking is available in the loading dock (1 bus) any additional buses may park along the sidewalk on the south side of the theatre (see picture below).

**SHORE POWER AND WATER IS AVAILABLE**

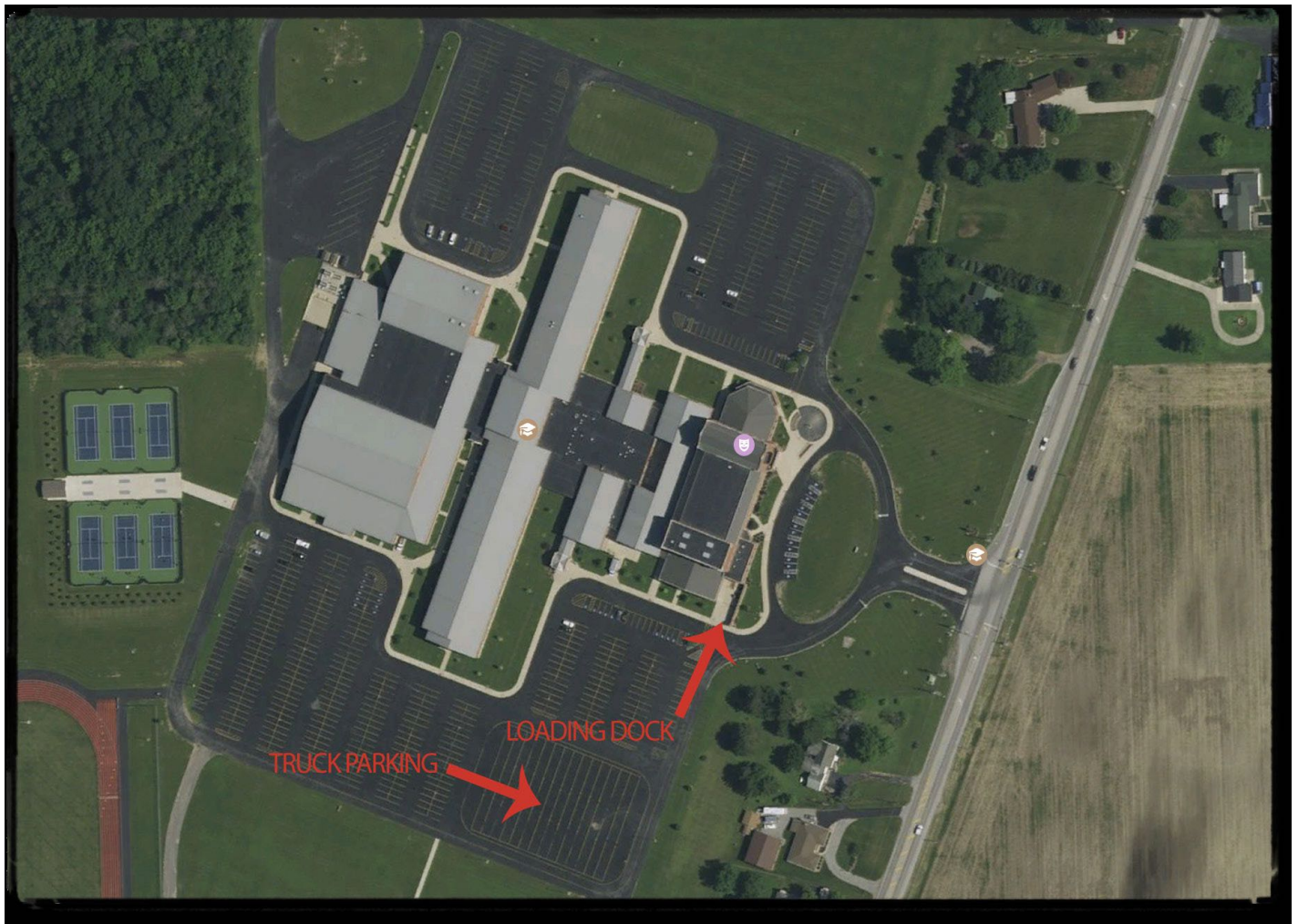





# VENUE BLUEPRINT

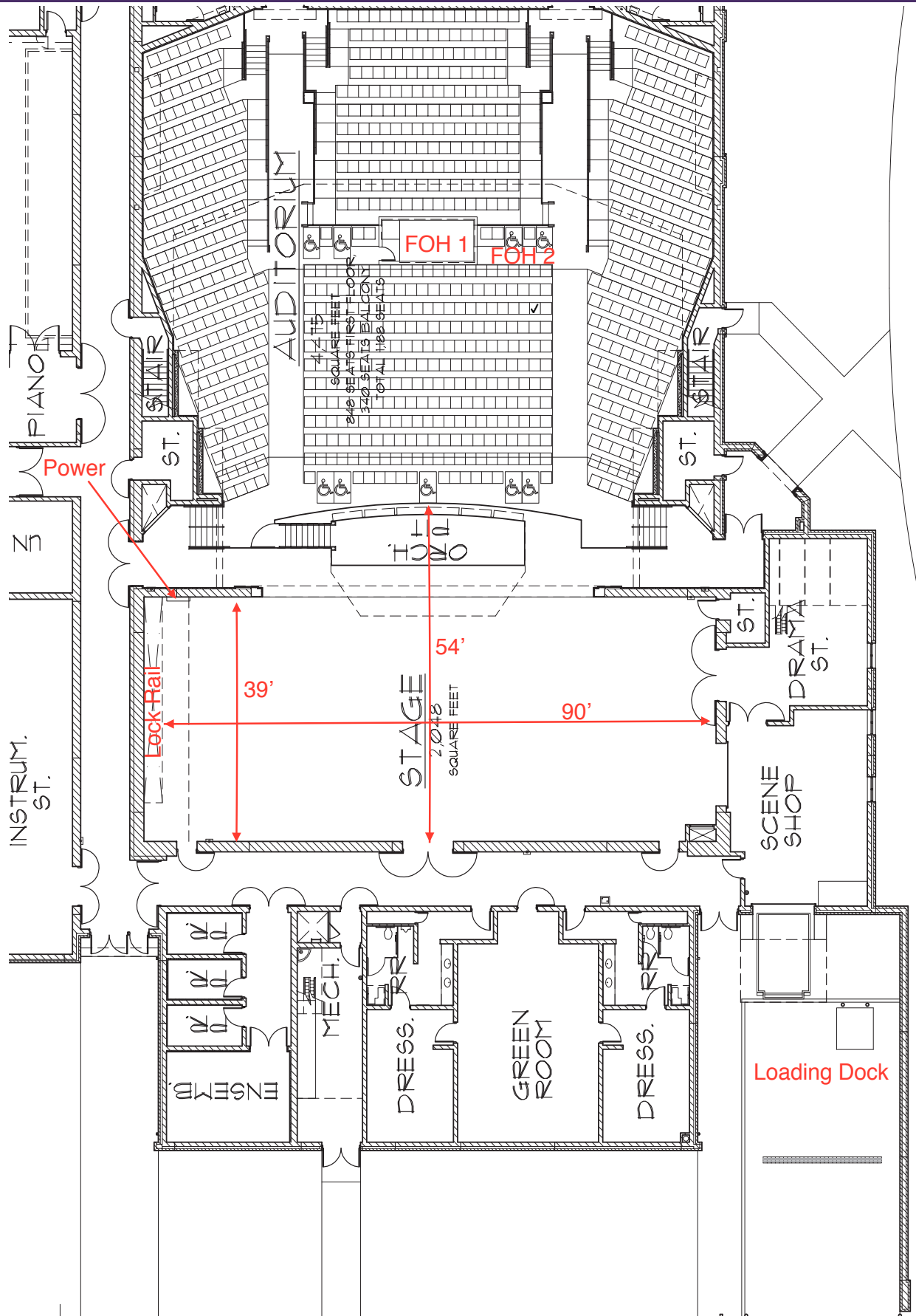



# STAGE DIMENSIONS

## Stage

Proscenium width 54'  
Proscenium height 19'-6"  
Stage width wall to wall 90'  
Stage depth PL/ back wall 39'  
Thrust edge / back wall 53'  
Wings 20'  
Grid height 54'  
Trim height 48'

## Orchestra Pit

Orchestra pit width 32'  
Orchestra pit depth 16'  
Orchestra pit cover width 32'  
Orchestra pit cover depth 8'  
Orchestra pit height 10'

## Risers

6 - 4x8 risers with adjustable leg lengths  
3 - 3x8 risers with adjustable leg lengths  
\*Black skirting is available\*



# FOH POSITIONS

## FOH

Touring lighting AND audio will be placed on the main floor located in the center of the Orchestra section of seats. (16'x6'6")

A secondary location may be added for touring production just to the House Left of the main production booth. (10'-8"x8')

## Spot Booths

Spot booths are located above the balcony exits approximately 68' from the DS edge.

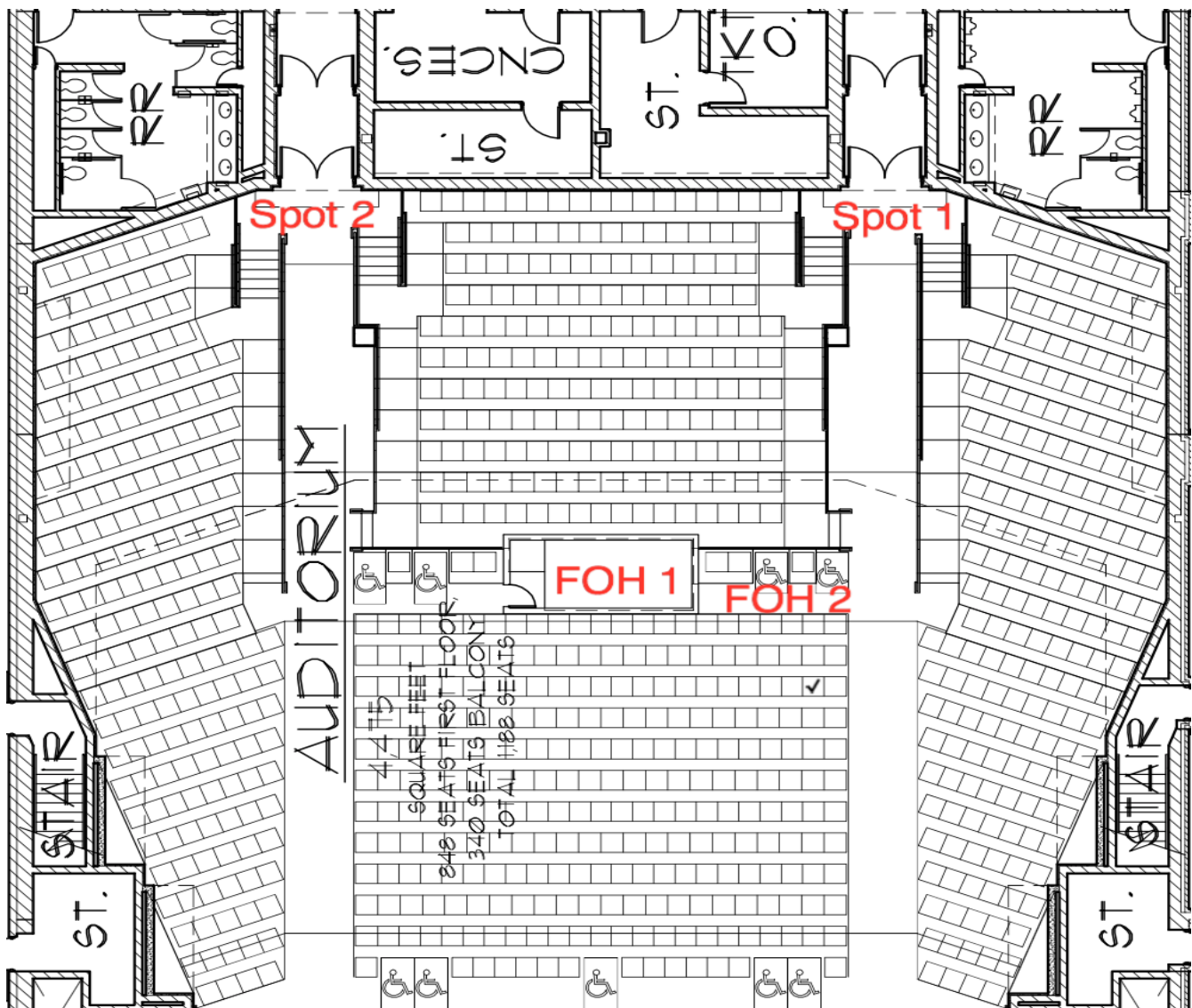



# RIGGING/POWER

## Line Sets

28 Single purchase counterweight arbors with a 1,200lb. capacity.

- \* Stage weights are 20lb. and 40lb.
- \* Battens are 74' long

*(See next page for House Line Set Schedule)*

## Soft Goods

- 4 - sets of Legs (24'x12')
- 1 - Mid-Stage Traveller (24'x38' per section)
- 5 - Borders (10'x74')
- 1 - Sharktooth Scrim (Black) (24'x74')
- 1 - Blackout (26'x24' per section)
- 1 - Cyclorama (24'x74')
- 1 - Red valance (12'x60')
- 1 - Main Curtain (22'x38') \*Motorized travel or guillotine\*
- 1 - Dead hung picture screen (motorized up and down)

## Motors

- 1 - One (1) ton stacking motor located USR or USL
- 2 - One (1) ton motors located DSL and DSR for Sound

## Power

- 1 - 100amp Cam-Lock disconnect (SL)
- 1 - 400amp Cam-Lock disconnect (SL)
- 6 - 20amp Edison circuits along US wall



# LINESET SCHEDULE

Distance Number House Item

**Show Item**

11"	1	Valance
2'-2"	2	Main Traveler
3'-4"	3	1 LX (perminent)
4'-6"	4	
6'-0"	5	1 Border
6'-6"	6	1 Leg
7'-0"	7	
7'-6"	8	
8'-0"	9	
10'-0"	10	2 Border
10'-6"	11	2 Leg
11'-6"	12	2 LX
14'-0"	13	
16'-0"	14	3 Border
17'-0"	15	Mid stage Traveler
18'-6"	16	
20'-6"	17	3LX
21'-6"	18	
23'-6"	19	4 Border
24'-0"	20	4 Leg
25'-6"	21	4LX
26'-0"	22	
31'-6"	23	5 Border
32'-0"	24	5 Leg
32'-6"	25	Cyc LX
36'-6"	26	
37'-0"	27	White Cyc
37'-6"	28	Blackout





# LIGHTING

## Fixtures

16 - 19° Source 4  
16 - 26° Source 4  
22 - 36° Source 4  
8 - 50° Source 4  
8 - 15/30° Zoom Source 4  
8 - 25/50° Zoom Source 4  
12 - 1k Colortran Fresnels  
4 - 2k Colortran Fresnels  
12- 1k Pars

## Intelligent Lighting

12 - Elation SixPar 300's  
12 - Elation SixPar 1000's

## Haze Usage

Use of haze is OK. However, smoke detectors **MUST** be capped upon approval by Tech Director. Haze will be monitored during the duration of the day by NPAC staff and touring production will be notified if concerns arise. While smoke detectors are capped, other detectors in ventilation areas may be activated. We will do everything we can to make sure your production is provided adequate atmospheric conditions.

## Spotlights

2 - Strong Canto spotlights w/  
5 color frames (located above  
balcony exits)

NOTE: A third spotlight may be  
added in the media booth if  
needed.

## Control

1 - GrandMA 3 Lite  
1 - Cat-5e line from DSL to FOH  
w/ a 4-universe adapter on  
each end

## House Lighting

Unison control system (can be  
patched into touring lighting  
consoles)



# AUDIO

## **FOH Mixing**

Yamaha Rivage PM5

## **FOH Mains**

20 (10 per side) - JBL VTX A8

6 (3 per side) - JBL VTX B28 Subs

## **Input devices**

Assorted SM58, SM57, Audix drum kit set.

Sennheiser Evolution G4 series wireless system.

-12 receivers

-12 body packs with countryman E6 mics

-6 handhelds

## **Cabling / Snake**

4 - 12 channel sub snakes

1 - 64 channel RPIO (Silk enabled)

1 - 32 channel analog split

1 - Dante network connection

## **Clearcom**

Communication is provided by Clearcom. 2 Channel hard wired system with access at all production positions. Paging in all hallways and rooms.



# VIDEO/MISCELLANEOUS

## **Projectors:**

1 - Christie DHD1051 (mounted in the balcony)

## **Playback:**

1 - Switcher/Scaler

2 - HDMI

1 - Apple Thunderbolt

2 - VGA

*\*PLEASE HAVE ALL NECESSARY ADAPTERS (HDMI/VGA)\**

## **Screen:**

1 - Dead hung screen position with motorized control (30'x12')

*\*Cyclorama can also be used for an upstage screen\**

## **Chairs:**

70 - All black Wenger straight back orchestra chairs

5 - All black Wenger Cello Chairs

## **Music Stands:**

+/- 150 - Wenger music stands



# VENUE PICTURES







# VENUE PICTURES

FOH 1 AND 2







# VENUE PICTURES

VIEW FROM FOH





# VENUE PICTURES

STAGE/RAIL







# VENUE PICTURES

GREEN ROOM







# VENUE PICTURES

Green Room







# VENUE PICTURES

Large Dressing Rooms







# VENUE PICTURES

Star Dressing Rooms







# VENUE PICTURES

Star Dressing Rooms





# VENUE PICTURES

Laundry Room







# VENUE PICTURES

Multi-Purpose Room







# VENUE PICTURES

PRACTICE ROOMS/ ADDITIONAL DRESSING ROOMS







# VENUE PICTURES

MEET AND GREET







# VENUE PICTURES

LOADING DOCK







# VENUE PICTURES

ADDITIONAL BUS PARKING





# **HOSPITALITY & MISCELLANEOUS INFORMATION**

Updated May 21, 2021





# HOTELS

---

## **Comfort Inn**

840 North Washington Street (U.S. 127)  
Van Wert, OH 45891  
(419) 232-6040  
comfortinn840@yahoo.com  
*Manager: Samantha*

## **Holiday Inn Express**

140 Valam Dr  
Van Wert, OH 45891  
(419) 238-2600  
HolidayInnExpressVW@gmail.com



# GREEN ROOM/DRESSING ROOMS

## **Green room includes:**

- 1 - Sink
- 1 - Microwave
- 1 - Refrigerator
- 2 - Couches
- 2 - Stuffed chairs
- 1 - Large conference table w/ chairs
- 4 - Medium tables w/ chairs for catering/dining

## **Dressing Rooms:**

2 rooms adjoined to the green room (Male/Female) that can accommodate up to 12 people. Each room is equipped with clothing racks, fabric steamer, and ironing board with steam iron. A wardrobe closet contains wash clothes, hand towels and bath towels. Adjoining each dressing room is a bathroom w/ shower.

## **Additional Dressing Rooms/Production Office:**

4 (3 small/1 large) Practice rooms are located within 15' of the Green room. These are typically used as additional dressing rooms or office space. If school is in session on a show day, the rooms will NOT be available until 3pm as they are used by the school's music department.



# MERCHANDISE

Merchandise will have a spot available in the lobby. The NPAC may provide an assistant to the traveling merchandise salesman at no additional charge. Performer merchandise set-up/details is handled by the Facility Coordinator, Michelle Agler. She can be advanced at 419-771-1170 or [facilities@npacvw.org](mailto:facilities@npacvw.org). Settlement of merchandise with the venue will be handled immediately following the event with Niswonger Executive Director, Tafi Stober or an appointed representative. Settlement will be handled according to terms in the contract. Tafi Stober can be reached in advance at 419-852-7353 or [showtime@npacvw.org](mailto:showtime@npacvw.org).





# AIRPORTS

## **\*Van Wert (Non-Commercial)**

1400 Lesson Ave  
Van Wert, OH 45891

Distance to: 2 miles/6min

## **\*Fort Wayne**

3801 W Ferguson Rd  
Fort Wayne, IN 46809

Distance to: 41 miles/49 min

## **\*Toledo**

11013 Airport Hwy  
Swanton, OH 43558

Distance to: 84 miles/1 hr 43 min

## **\*Dayton**

3600 Terminal Dr  
Dayton, OH 45377

Distance to: 91 miles/1 hr 27 min

**\*Presenter ground transportation available**

## **Columbus**

4600 International Gtwy  
Columbus, OH 43219

Distance to: 131 miles/ 2 hr 16 min

## **Cincinnati**

3087 Terminal Dr  
Cincinnati, KY 41048

Distance to: 163 miles/2 hr 42 min

## **Indianapolis**

7800 Col H Weir Cook Memorial Dr  
Indianapolis, IN 46241-8000

Distance to: 171 miles/ 2 hr 40 min

## **Detroit Metropolitan**

1 Detroit Metropolitan Airport  
Romulus, MI 48242

Distance to: 140 miles/2 hr 18 min

## **Chicago**

### **Midway**

5700 S Cicero Ave  
Chicago, IL 60638

Distance to: 207 miles/3 hr 44 min

### **O'Hare**

10000 West O'Hare Ave  
Chicago, IL 60666



**LECTURE HALL  
AND  
PRESENTER INFORMATION**

Updated May 21, 2021





# LECTURE HALL OVERVIEW

## Audio

- 2 - Wireless handheld microphones
- 1 - Wired microphone
- 1 - audio input for laptop or handheld device sound

## Video

- 1 - State of the art projector
- 1 - projector screen (motorized)
- 1 - VGA input for laptops

*\*PLEASE HAVE ALL NECESSARY ADAPTERS (HDMI/VGA)\**

## Miscellaneous

- 1 - Lecturn
- 1 - 6' table
- 1 - Wall mounted white board
- 1 - Kitchnette (located at the back of the room)

## Connectivity

- \*Each pair of seats has A/C and internet connectivity
- \*Stage connectivity for A/C and internet



# SEAT MAP

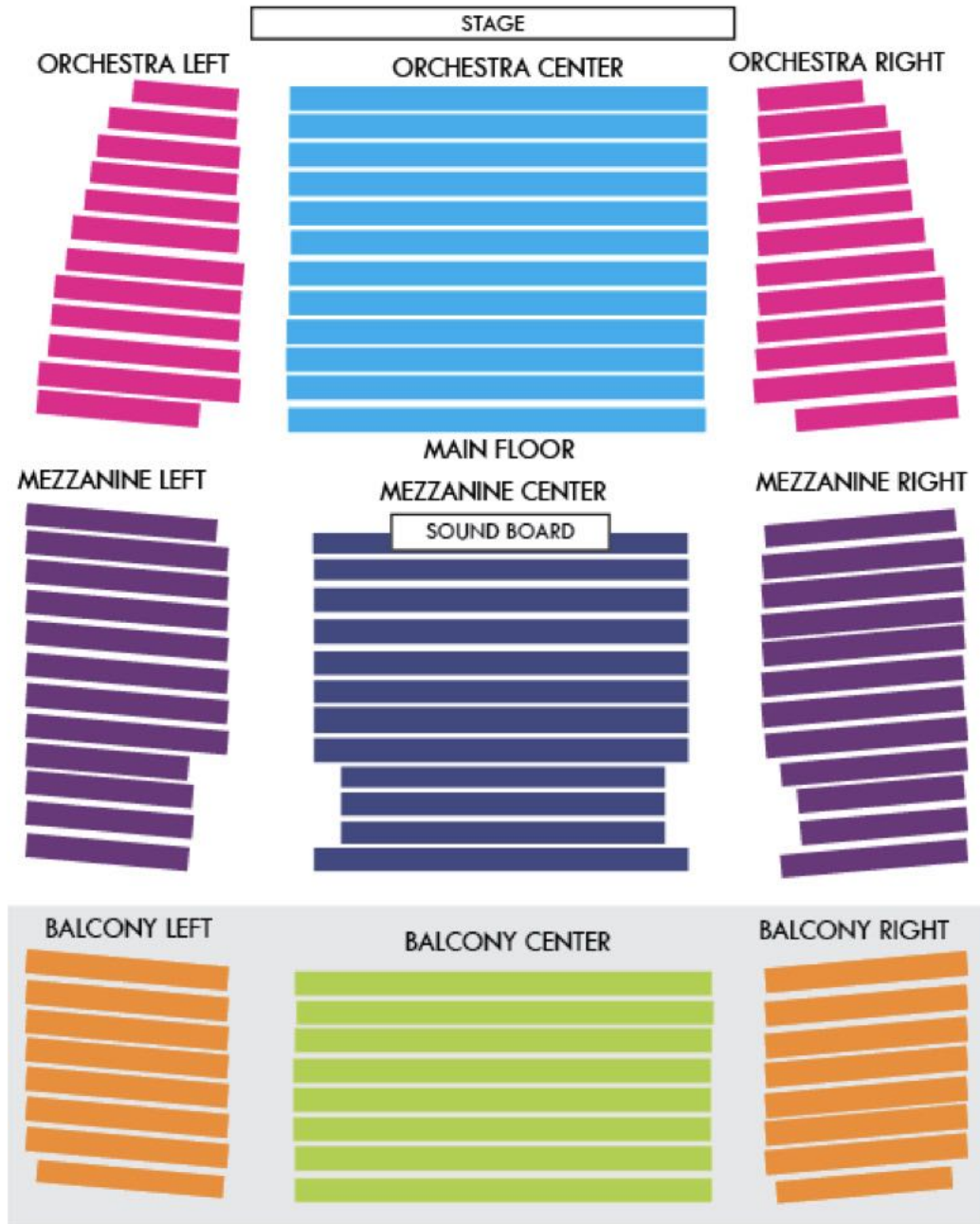

## SEATING SECTION & PRICING COLOR CODES







# AMENITIES

---

## WIFI

Complimentary wifi is available throughout the venue.

Network Name: NPAC\_Artist

Password: \*to be determined, but will be show specific\*

## PHONES

A phone with an outside line is provided in the Green Room.

There is also direct lines to each department supervisor.