



VENUE PACKET

Updated January 2025



TABLE OF CONTENTS

1	Venue Contacts
2	Truck/Bus Parking
3	Venue Layout/Dimensions
4	Stage Dimensions
5	FOH Positions
6	Rigging/Power
7	Lineset Schedule
8	Lighting
9	Audio
10	Video
11	Venue Pictures
26	Hotels
27	Green Room/Dressing Room
28	Merchandise
29	Airports
30	Lecture Hall/Presenter Info
31	Box Office Seating Chart
32	Amenities



VENUE CONTACTS

NISWONGER PERFORMING ARTS CENTER

10700 State Route 118 South
Van Wert, OH 45891
United States

Executive Director:

Booking/Contract Info

Jarin Hart

419-771-1176

showtime@npacvw.org

House Manager:

Hospitality

Madison Bronson

419-771-1170

madison@npacvw.org

Marketing Director:

Quincy Thompson

419-771-1173

quincy@npacvw.org

Technical Director:

Michael Brett

419-771-1177

michael@npacvw.org

Box Office Manager:

Amy McGovern

419-238-6722

boxoffice@npacvw.org



PARKING/LOADING DOCK

1 - truck dock at street level. 12'X8' lift platform to unload.

NOTE: All areas are street level.

*Bus parking is available in the loading dock (1 bus) any additional buses may park along the sidewalk on the south side of the theatre (see picture below).

SHORE POWER AND WATER IS AVAILABLE

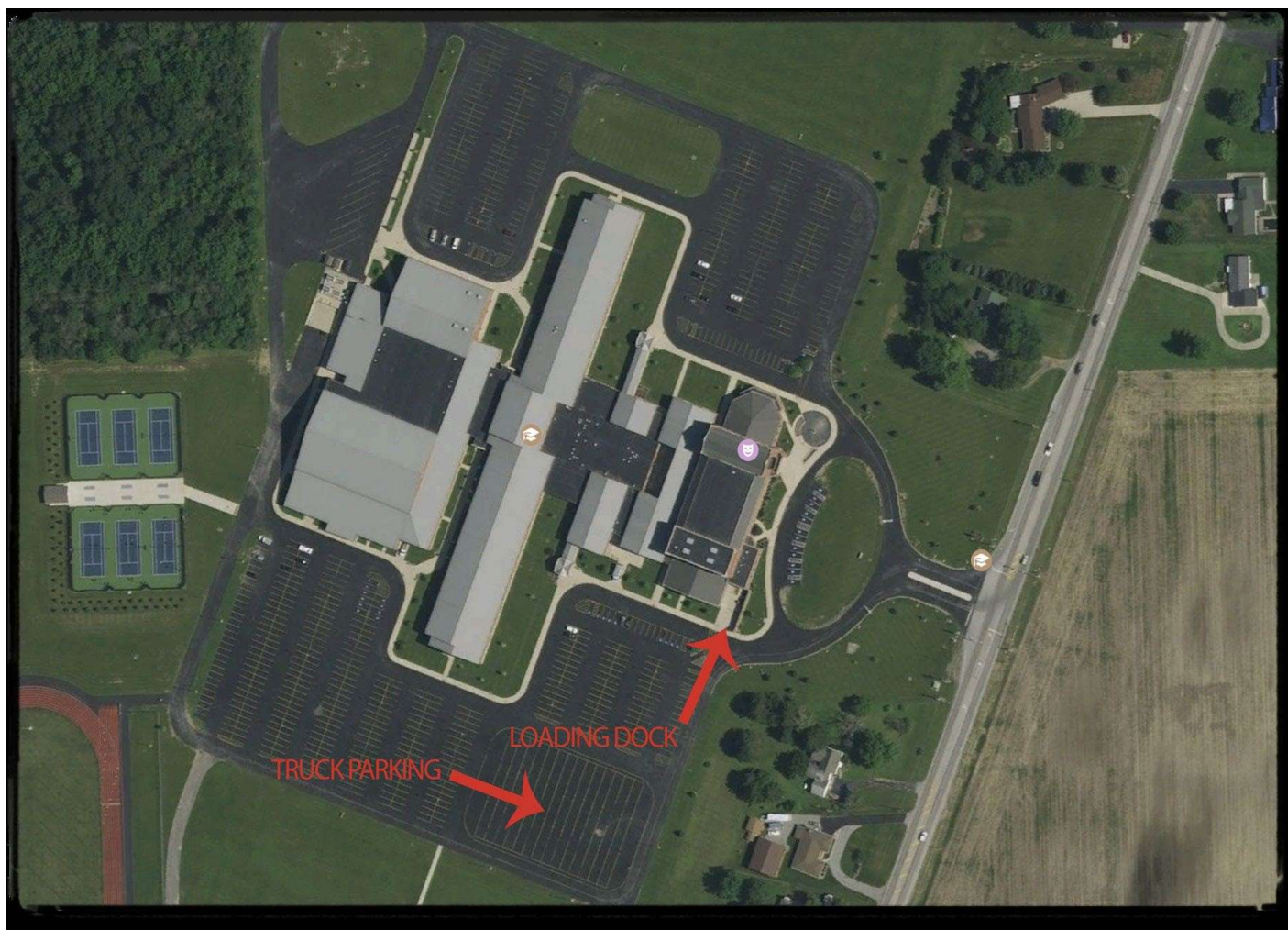



VENUE BLUEPRINT

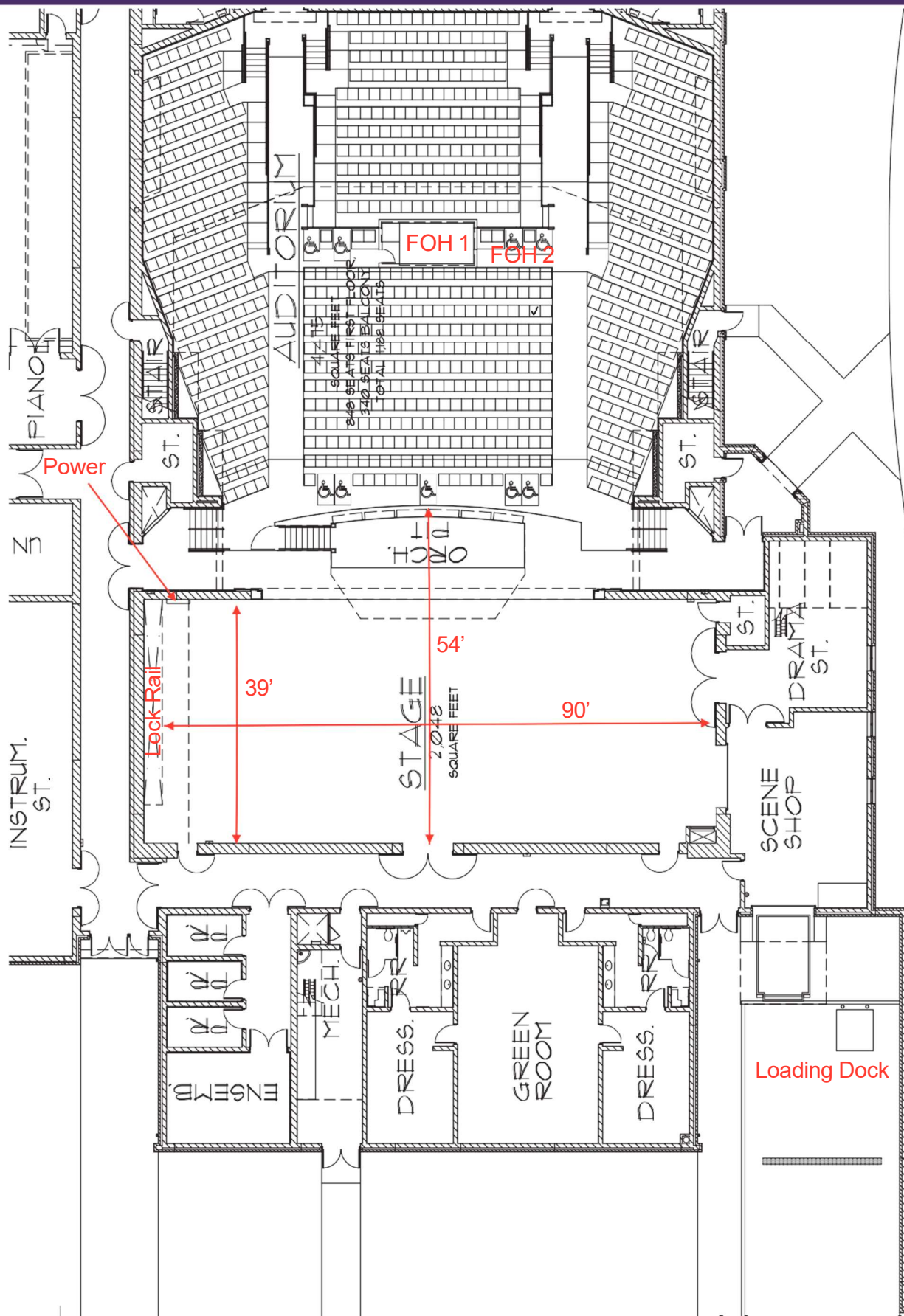



STAGE DIMENSIONS

Stage

Proscenium width 54'
Proscenium height 19'-6"
Stage width wall to wall 90'
Stage depth PL/ back wall 39'
Thrust edge / back wall 53'
Wings 20'
Grid height 54'
Trim height 48'

Orchestra Pit

Orchestra pit width 32'
Orchestra pit depth 16'
Orchestra pit cover width 32'
Orchestra pit cover depth 8'
Orchestra pit height 10'

Risers

6 - 4x8 risers with adjustable leg lengths
3 - 3x8 risers with adjustable leg lengths
Black skirting is available



FOH POSITIONS

FOH

Touring lighting AND audio will be placed on the main floor located in the center of the Orchestra section of seats. (16'x6'6")

A secondary location may be added for touring production just to the House Left of the main production booth. (10'-8"x8')

Spot Booths

Spot booths are located above the balcony exits approximately 68' from the DS edge.

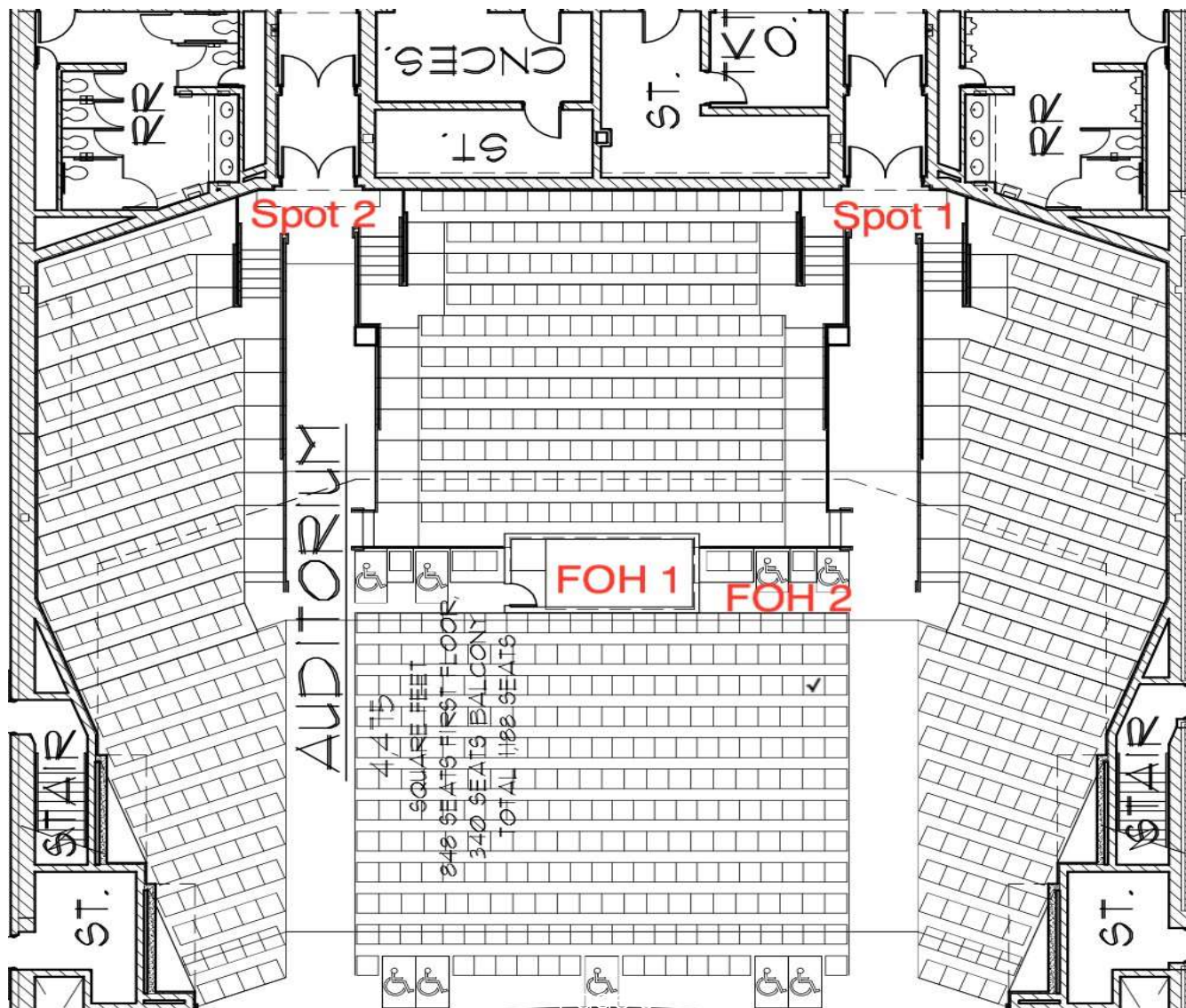



RIGGING/POWER

Line Sets

- 28 Single purchase counterweight arbors with a 1,200lb. capacity.
 - * Stage weights are 20lb. and 40lb.
 - * Battens are 74' long

(See next page for House Line Set Schedule)

Soft Goods

- 4 - sets of Legs (24'x12')
- 1 - Mid-Stage Traveler (24'x38' per section)
- 5 - Borders (10'x74')
- 1 - Shark tooth Scrim (Black) (24'x74')
- 1 - Blackout (26'x24' per section)
- 1 - Cyclorama (24'x74')
- 1 - Red valance (12'x60')
- 1 - Main Curtain (22'x38') *Motorized travel or guillotine*
- 1 - Dead hung picture screen (motorized up and down)

Motors

- 1 - One (1) ton stacking motor located USR or USL
- 2 - One (1) ton motors located DSL and DSR for Sound

Power

- 1 - 100amp Cam-Lock disconnect (SL)
- 1 - 400amp Cam-Lock disconnect (SL)
- 6 - 20amp Edison circuits along US wall



LINESET SCHEDULE

Distance Number House Item

Show Item

11"	1	Valance
2'-2"	2	Main Traveler
3'-4"	3	1 LX (permanent)
4'-6"	4	
6'-0"	5	1 Border
6'-6"	6	1 Leg
7'-0"	7	
7'-6"	8	
8'-0"	9	
10'-0"	10	2 Border
10'-6"	11	2 Leg
11'-6"	12	2 LX
14'-0"	13	
16'-0"	14	3 Border
17'-0"	15	Mid stage Traveler
18'-6"	16	
20'-6"	17	3LX
21'-6"	18	
23'-6"	19	4 Border
24'-0"	20	4 Leg
25'-6"	21	4LX
26'-0"	22	
31'-6"	23	5 Border
32'-0"	24	5 Leg
32'-6"	25	Cyc LX
36'-6"	26	
37'-0"	27	White Cyc
37'-6"	28	Blackout



LIGHTING

Fixtures

16 - 19° Source 4
16 - 26° Source 4
22 - 36° Source 4
8 - 50° Source 4
8 - 15/30° Zoom Source 4
8 - 25/50° Zoom Source 4
12 - 1k Colortran Fresnels
4 - 2k Colortran Fresnels
12- 1k Pars

Intelligent Lighting

12 - Elation SixPar 300's
12 - Elation SixPar 1000's

Haze Usage

Use of haze is OK. However, smoke detectors **MUST** be capped upon approval by Tech Director. Haze will be monitored during the duration of the day by NPAC staff and touring production will be notified if concerns arise. While smoke detectors are capped, other detectors in ventilation areas may be activated. We will do everything we can to make sure your production is provided adequate atmospheric conditions.

Spotlights

2 - Strong Canto spotlights w/ 5 color frames (located above balcony exits)
NOTE: A third spotlight may be added in the media booth if needed.

Control

1 - GrandMA 3 Lite
1 - Cat-5e line from DSL to FOH w/ a 4-universe adapter on each end

House Lighting

Unison control system (can be patched into touring lighting consoles)



AUDIO

FOH Mixing

Yamaha Rivage PM5

FOH Mains

20 (10 per side) - JBL VTX A8

6 (3 per side) - JBL VTX B28 Subs

Input devices

Assorted SM58, SM57, Audix drum kit set.

Sennheiser Evolution G4 series wireless system.

-12 receivers

-12 body packs with countryman E6 mics

-6 handhelds

Cabling / Snake

4 - 12 channel sub snakes

1 - 64 channel RPIO (Silk enabled)

1 - 32 channel analog split

1 - Dante network connection

Clearcom

Communication is provided by Clearcom. 2 Channel hard wired system with access at all production positions. Paging in all hallways and rooms.



VIDEO/MISCELLANEOUS

Projectors:

- 1 - Christie DHD1051 (mounted in the balcony)

Playback:

- 1 - Switcher/Scaler
- 2 - HDMI
- 1 - Apple Thunderbolt
- 2 - VGA

PLEASE HAVE ALL NECESSARY ADAPTERS (HDMI/VGA)

Screen:

- 1 - Dead hung screen position with motorized control (30'x12')
- *Cyclorama can also be used for an upstage screen**

Chairs:

- 70 - All black Wenger straight back orchestra chairs
- 5 - All black Wenger Cello Chairs

Music Stands:

- +/- 150 - Wenger music stands



VENUE PICTURES

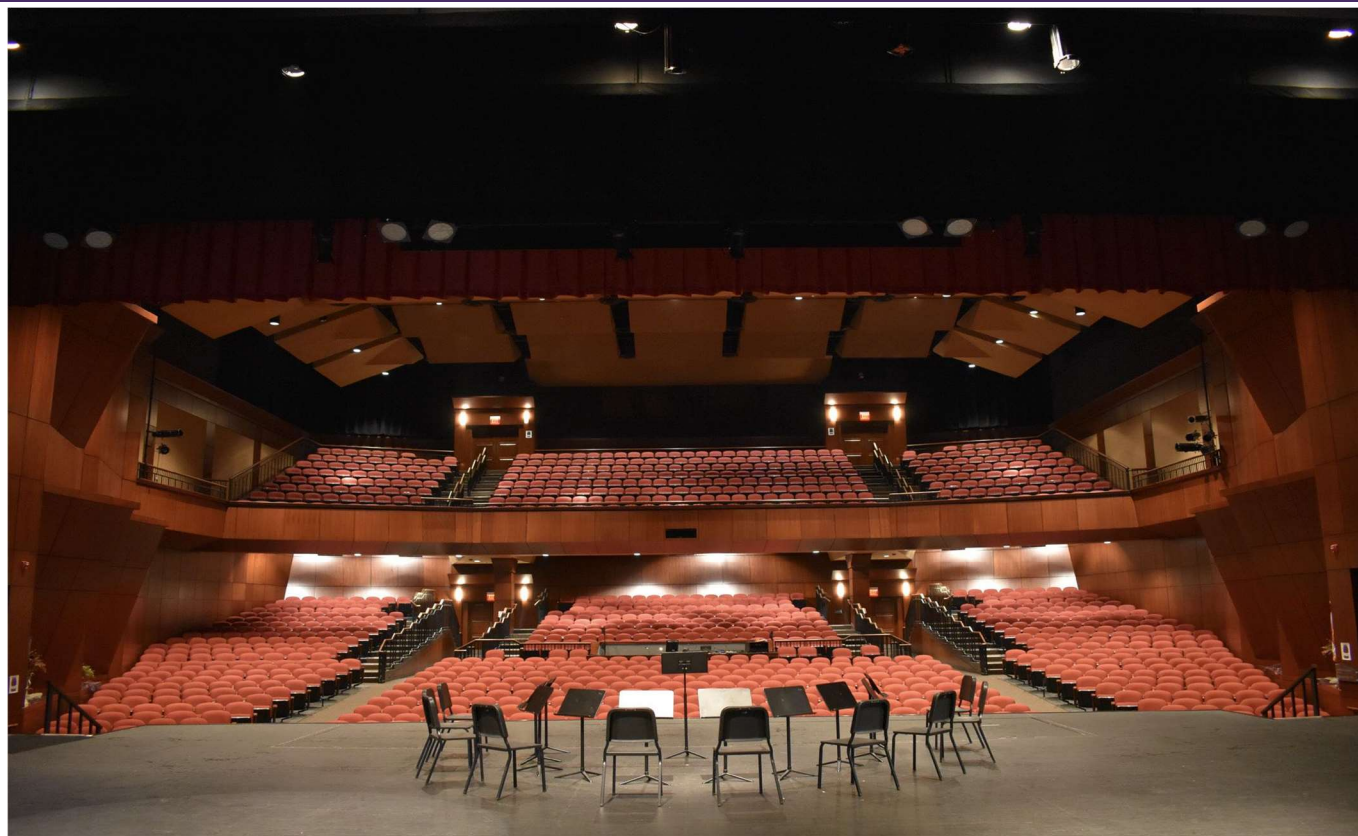



VENUE PICTURES

FOH 1 AND 2

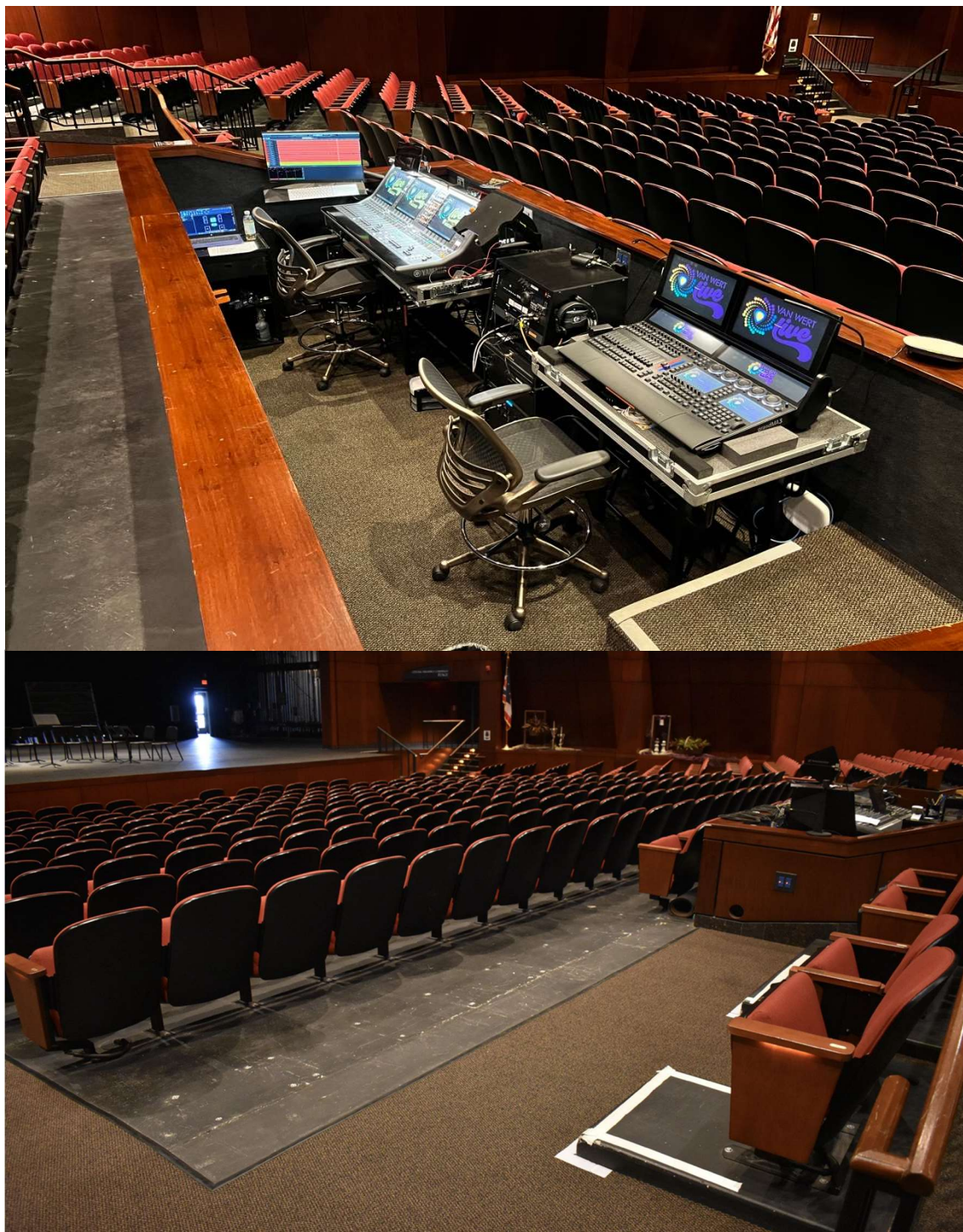



VENUE PICTURES

VIEW FROM FOH





VENUE PICTURES

STAGE/RAIL

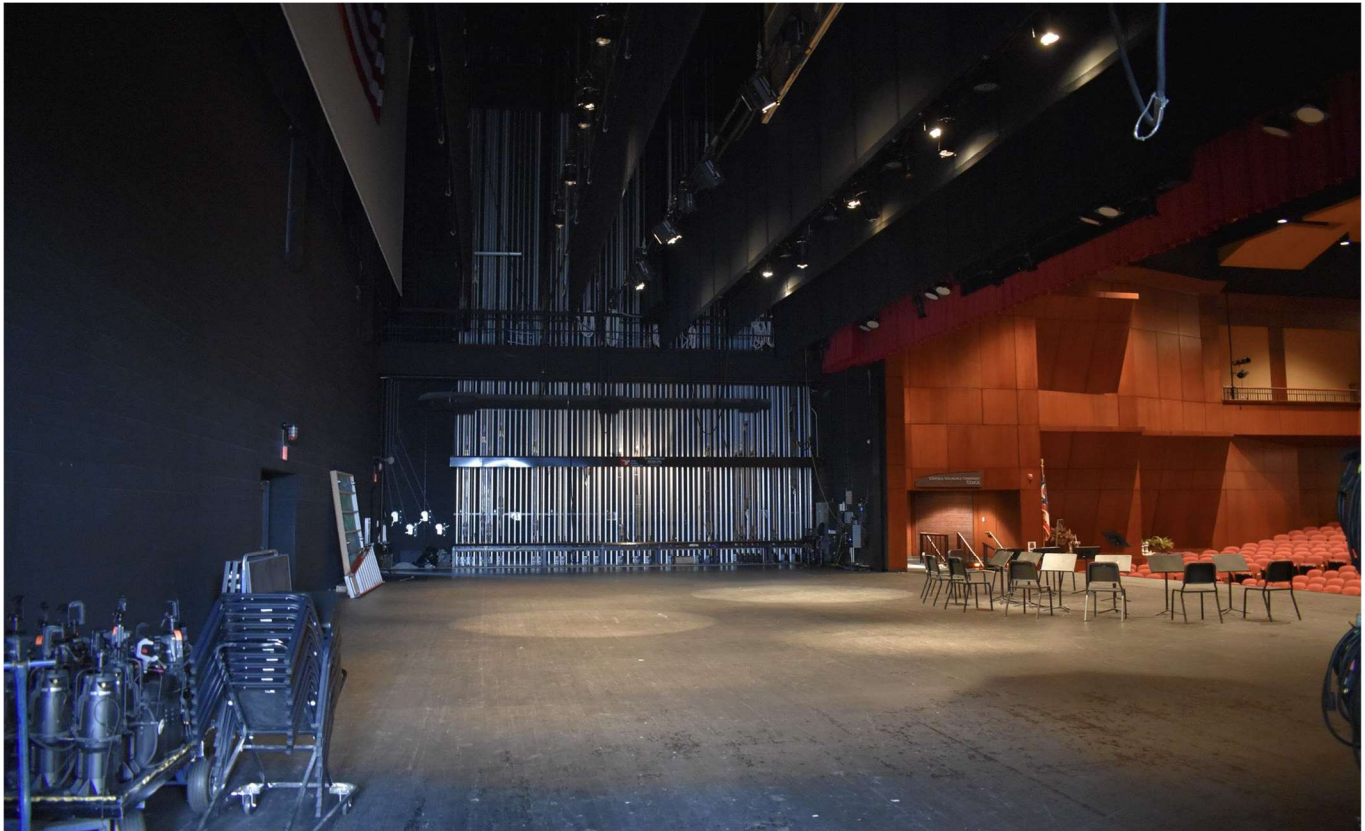



VENUE PICTURES

GREEN ROOM





VENUE PICTURES

Green Room





VENUE PICTURES

Large Dressing Rooms





VENUE PICTURES

Star Dressing Rooms





VENUE PICTURES

Star Dressing Rooms





VENUE PICTURES

Laundry Room





VENUE PICTURES

Multi-Purpose Room





VENUE PICTURES

PRACTICE ROOMS/ ADDITIONAL DRESSING ROOMS

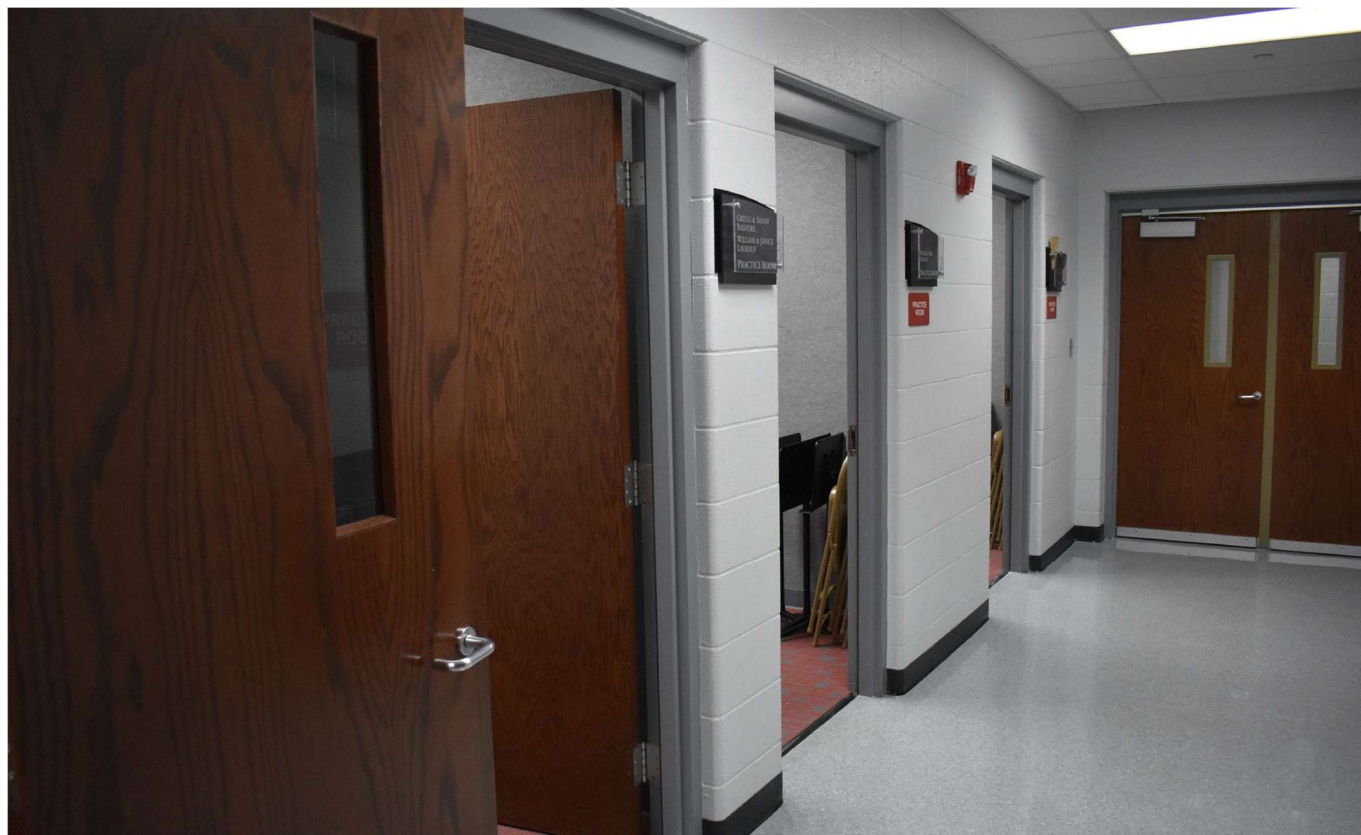



VENUE PICTURES

MEET AND GREET





VENUE PICTURES

LOADING DOCK





VENUE PICTURES

ADDITIONAL BUS PARKING





HOSPITALITY & MISCELLANEOUS INFORMATION

Updated May 21, 2021



HOTELS

Comfort Inn

840 North Washington Street (U.S. 127)

Van Wert, OH 45891

(419) 232-6040

comfortinn840@yahoo.com

Manager: Samantha

Holiday Inn Express

140 Valam Dr

Van Wert, OH 45891

(419) 238-2600

HolidayInnExpressVW@gmail.com



GREEN ROOM/DRESSING ROOMS

Green room includes:

- 1 - Sink
- 1 - Microwave
- 1 - Refrigerator
- 2 - Couches
- 2 - Stuffed chairs
- 1 - Large conference table w/ chairs
- 4 - Medium tables w/ chairs for catering/dining

Dressing Rooms:

2 rooms adjoined to the green room (Male/Female) that can accommodate up to 12 people. Each room is equipped with clothing racks, fabric steamer, and ironing board with steam iron. A wardrobe closet contains wash clothes, hand towels and bath towels. Adjoining each dressing room is a bathroom w/ shower.

Additional Dressing Rooms/Production Office:

4 (3 small/1 large) Practice rooms are located within 15' of the Green room. These are typically used as additional dressing rooms or office space. If school is in session on a show day, the rooms will NOT be available until 3pm as they are used by the school's music department.



MERCHANDISE

Merchandise will have a spot available in the lobby. Van Wert LIVE may provide an assistant to the traveling merchandise salesman at no additional charge. Performer merchandise set-up/details is handled by the Facility Coordinator. They can be advanced at 419-771-1170 or facilities@npacvw.org. Settlement of merchandise with the venue will be handled immediately following the event with Niswonger Executive Director, Jarin Hart or an appointed representative. Settlement will be handled according to terms in the contract. Jarin Hart can be reached in advance at showtime@npacvw.org.



AIRPORTS

***Van Wert (Non-Commercial)**

1400 Lesson Ave
Van Wert, OH 45891

Distance to: 2 miles/6min

***Fort Wayne**

3801 W Ferguson Rd
Fort Wayne, IN 46809

Distance to: 41 miles/49 min

***Toledo**

11013 Airport Hwy
Swanton, OH 43558

Distance to: 84 miles/1 hr 43 min

***Dayton**

3600 Terminal Dr
Dayton, OH 45377

Distance to: 91 miles/1 hr 27 min

***Presenter ground transportation available**

Columbus

4600 International Gtway
Columbus, OH 43219

Distance to: 131 miles/ 2 hr 16 min

Cincinnati

3087 Terminal Dr
Cincinnati, KY 41048

Distance to: 163 miles/2 hr 42 min

Indianapolis

7800 Col H Weir Cook Memorial Dr
Indianapolis, IN 46241-8000

Distance to: 171 miles/ 2 hr 40 min

Detroit Metropolitan

1 Detroit Metropolitan Airport
Romulus, MI 48242

Distance to: 140 miles/2 hr 18 min

Chicago

Midway

5700 S Cicero Ave
Chicago, IL 60638

Distance to: 207 miles/3 hr 44 min

O'Hare

10000 West O'Hare Ave
Chicago, IL 60666



LECTURE HALL AND PRESENTER INFORMATION

Updated May 21, 2021



LECTURE HALL OVERVIEW

Audio

- 2 - Wireless handheld microphones
- 1 - Wired microphone
- 1 - audio input for laptop or handheld device sound

Video

- 1 - State of the art projector
- 1 - projector screen (motorized)
- 1 - VGA input for laptops

PLEASE HAVE ALL NECESSARY ADAPTERS (HDMI/VGA)

Miscellaneous

- 1 - Lecturn
- 1 - 6' table
- 1 - Wall mounted white board
- 1 - Kitchnette (located at the back of the room)

Connectivity

- *Each pair of seats has A/C and internet connectivity
- *Stage connectivity for A/C and internet



SEAT MAP

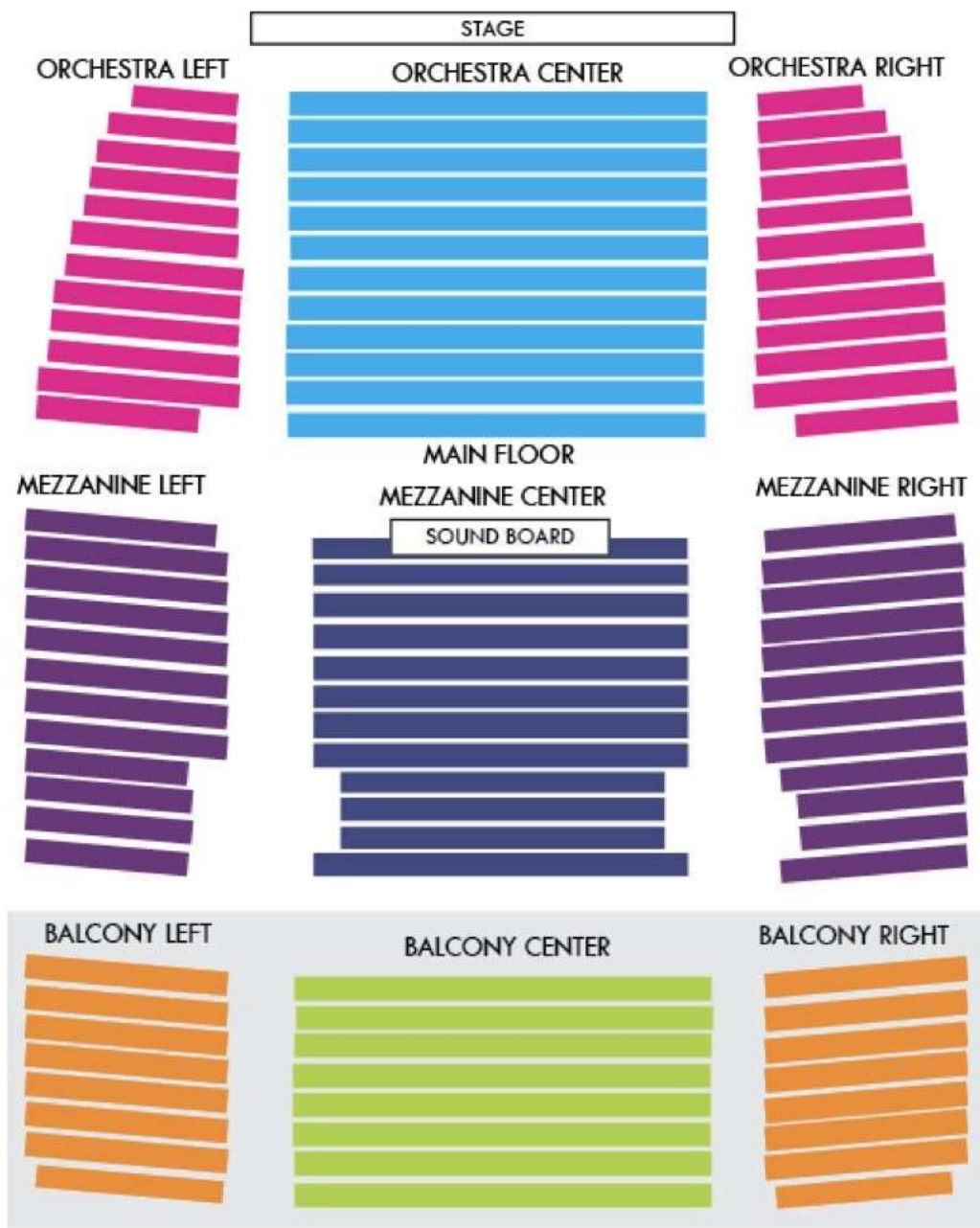

SEATING SECTION & PRICING COLOR CODES





AMENITIES

WIFI

Complimentary wifi is available throughout the venue.

Network Name: NPAC_Artist

Password: *There is no password protection*

PHONES

A phone with an outside line is provided in the Green Room.

There is also direct lines to each department supervisor.